

EROSION CONTROL BEST MANAGEMENT PRACTICES

BEST MANAGEMENT PRACTICE	LOCATION	IMPLEMENTATION SCHEDULE	MAINTENANCE SCHEDULE
PRESERVING EXISTING WETLAND	AROUND PERIMETER OF PROJECT SITE AS SHOWN	CONTINUOUS, UNTIL CONSTRUCTION IS COMPLETED	EDUCATE EMPLOYEES AND SUBCONTRACTORS REGARDING IMPORTANCE OF AVOIDANCE JURISDICTIONAL WETLANDS AND MAINTAINING EXISTING VEGETATION TO PREVENT EROSION AND FILER AND SEDIMENT IN RUNOFF FROM DISTURBED AREAS ON THE CONSTRUCTION SITE. INSPECT SITE PERIMETER MONTHLY TO VERIFY THE OUTSIDE VEGETATION IS NOT DISTURBED.
PROTECT GRADED AREAS AND SLOPES FROM WASHOUT & EROSION	THROUGHOUT PROJECT SITE	DURING WET SEASON	INSPECT GRADED AREAS AND SLOPES ON AT LEAST A MONTHLY BASIS TO CHECK FOR EROSION. REGRADE TRIBUTARY AREAS OR INSTALL FILTER BARRIER OR SAND BAG DIKES AS NECESSARY TO PREVENT EROSION.
GRAVEL FILTER	ALONG FLOW LINES OF UNPAVED ROADWAYS WITHIN SITE	IN PLACE DURING WET SEASON UNTIL ROADWAYS ARE PAVED	INSPECT DAILY AND AFTER EACH STORM. REMOVE ONSITE SEDIMENT DEPOSITED BEHIND BERM OR BARRIER TO MAINTAIN EFFECTIVENESS.
SILT FENCING/FIBER ROLL	AS SHOWN	CONTINUOUS AS NECESSARY	INSPECT AFTER EACH STORM. REMOVE SEDIMENT DEPOSITED BEHIND FENCING WHENEVER NECESSARY TO MAINTAIN EFFECTIVENESS.
HANDBROADCAST WITH CEREAL BARLEY	ALL SLOPES AND EXPOSED DISTURBED AREAS	IN PLACE DURING BY OCT. 1	
STABILIZED CONSTRUCTION ENTRANCE	ENTRANCES TO SITE FROM PUBLIC ROADWAYS	CONTINUOUS, UNTIL ENTRANCES AND ONSITE ROADWAYS ARE PAVED	INSPECT ON A MONTHLY BASIS AND AFTER EACH RAINFALL. ADD AGGREGATE BASE MATERIAL WHENEVER NECESSARY TO PREVENT SEDIMENT FROM BEING TRACKED INTO PUBLIC STREET.
WIND EROSION CONTROL PRACTICES	WHEREVER NECESSARY THROUGHOUT PROJECT SITE.	CONTINUOUS UNTIL GRADING IS COMPLETED AND SOILS HAVE STABILIZED	INSPECT SITE DURING WINDY CONDITIONS TO IDENTIFY AREAS WHERE WIND EROSION IS OCCURRING AND ABATE EROSION AS NECESSARY
GOOD HOUSEKEEPING MEASURES	THROUGHOUT PROJECT SITE	CONTINUOUS UNTIL CONSTRUCTION IS COMPLETED	INSPECT SITE ON AT LEAST A MONTHLY BASIS TO VERIFY THAT GOOD HOUSEKEEPING PRACTICES ARE BEING IMPLEMENTED.
PROPER CONSTRUCTION MATERIAL STORAGE	DESIGNATED AREA	CONTINUOUS UNTIL CONSTRUCTION IS COMPLETED	INSPECT SITE ON AT LEAST A WEEKLY BASIS TO VERIFY THAT CONSTRUCTION MATERIALS ARE STORED IN A MANNER WHICH COULD NOT CAUSE STORM WATER POLLUTION.
PROPER CONSTRUCTION WASTE STORAGE AND DISPOSAL INCLUDING 1) CONCRETE	DESIGNATED COLLECTION AREA AND CONTAINERS	CONTINUOUS UNTIL CONSTRUCTION IS COMPLETED	INSPECT SITE ON AT LEAST A WEEKLY BASIS TO ASSURE WASTE IS STORED PROPERLY AND DISPOSED OF AT LEGAL DISPOSAL SITE, DAILY.
SPILL CLEANUP INCLUDING 1) PAINT & PAINTING SUPPLIES 2) VEHICLE FUELING MAINTENANCE & CLEANING	MATERIAL HANDLING AREA DESIGNATED AREA WITH SECONDARY CONTAINMENT	IMMEDIATELY AT TIME OF SPILL CONTINUOUS	INSPECT MATERIAL HANDLING AREAS ON AT LEAST A MONTHLY BASIS TO VERIFY PROPER SPILL CLEANUP. KEEP AMPLE SUPPLIES OF SPILL CLEANUP MATERIALS ON SITE & INSPECT ON REGULAR SCHEDULE.
STREET AND STORM DRAINAGE FACILITY MAINTENANCE DEFINITIONS	STREETS AND STORM DRAINAGE FACILITIES	CONTINUOUS UNTIL CONSTRUCTION IS COMPLETED	MAINTAIN STORM DRAINAGE FACILITIES AND PAVED STREETS CLEAR OF SEDIMENT AND DEBRIS.

1. WET SEASON- ENTIRE PERIOD BETWEEN OCTOBER 1 THROUGH APRIL 30. CONTRACTOR SHALL ALSO IMPLEMENT WET SEASON MEASURES IF WET WEATHER IS EXPECTED DURING THE DRY SEASON.
2. PHASES OF GRADING
INITIAL- WHEN CLEARING AND GRUBBING ACTIVITIES OCCUR.
ROUGH- WHEN CUT AND FILL ACTIVITIES OCCUR AND THE SITE IMPROVEMENTS ARE CONSTRUCTED, INCLUDING UNDERGROUND PIPING, STREETS, SIDEWALKS, AND OTHER IMPROVEMENTS.
FINAL- WHEN FINAL ELEVATIONS ARE SET, AND SITE IMPROVEMENTS ARE COMPLETED AND READY FOR NSCR AND STATE PARKS.

EROSION CONTROL PLAN NOTES:

1. GRADING ON THE SITE WILL BE LIMITED TO THE EXCAVATION SHOWN ON THE PLAN
2. SILT FENCE OR STRAW BALE SEDIMENT BARRIERS WILL BE INSTALLED PRIOR TO ANY GRADING ON THE SITE AND WILL BE OPERABLE DURING THE RAINY SEASON, OCTOBER 1 TO APRIL 30.
3. ALL MOVEMENT OF EARTH SHALL COMPLY WITH THE SPECIFICATIONS CONTAINED IN THE STATE OF CALIFORNIA DEPARTMENT OF TRANSPORTATION (CALTRANS) STANDARD SPECIFICATIONS 2006 SECTION 20.
4. CHANGES TO THIS EROSION AND SEDIMENT CONTROL PLAN TO MEET FIELD CONDITIONS, WILL BE MADE ONLY WITH THE APPROVAL OF/OR AT THE DIRECTION OF NSCR AND/OR THE DIVISION OF STATE PARK & RECREATION.
5. BETWEEN OCTOBER 1 AND APRIL 30, ALL PAVED AREAS WILL BE KEPT CLEAR OF EARTH MATERIAL AND DEBRIS. THE SITE WILL BE MAINTAINED SO THAT A MINIMUM OF SEDIMENT-LADEN RUNOFF LEAVES THE SITE.
6. THE CONTRACTOR WILL INFORM ALL CONSTRUCTION SITE WORKERS ABOUT THE MAJOR PROVISIONS OF THE EROSION AND SEDIMENT CONTROL PLAN AND SEEK THEIR COOPERATION IN AVOIDING THE DISTURBANCE OF THESE CONTROL MEASURES.
7. EXISTING VEGETATION SHALL BE MAINTAINED ON THE CONSTRUCTION SITE TO THE MAXIMUM EXTENT FEASIBLE. WETLANDS SHALL BE APPROVED AND TREES SHALL BE PROTECTED FROM DAMAGE BY PROPER GRADING TECHNIQUES.
8. AREAS OF DISTURBED SOIL SHALL BE RESEEDED AND COVERED WITH VEGETATION AS SOON AS POSSIBLE AFTER DISTURBANCE, BUT NO LESS THAN ONE HUNDRED (100) PERCENT COVERAGE OUTSIDE BUILDING AND ENTRANCE AREA NINETY (90) DAYS AFTER SEEDING; WEED-FREE MULCHES CONSISTING OF CERTIFIED WEED-FREE RICE STRAW MAY BE USED TO COVER GROUND AREAS TEMPORARILY.

MAINTENANCE NOTES:

1. DURING THE RAINY SEASON (OCTOBER 1 TO APRIL 30) ALL SEDIMENT BARRIERS WILL BE INSPECTED AND REPAIRED AT THE END OF EACH WORKING DAY AND IN ADDITION, AFTER EACH STORM.
2. SEEDED AREAS WILL BE REPAIRED, RESEEDED AND MULCHED AS SOON AS POSSIBLE AFTER BEING DAMAGED.

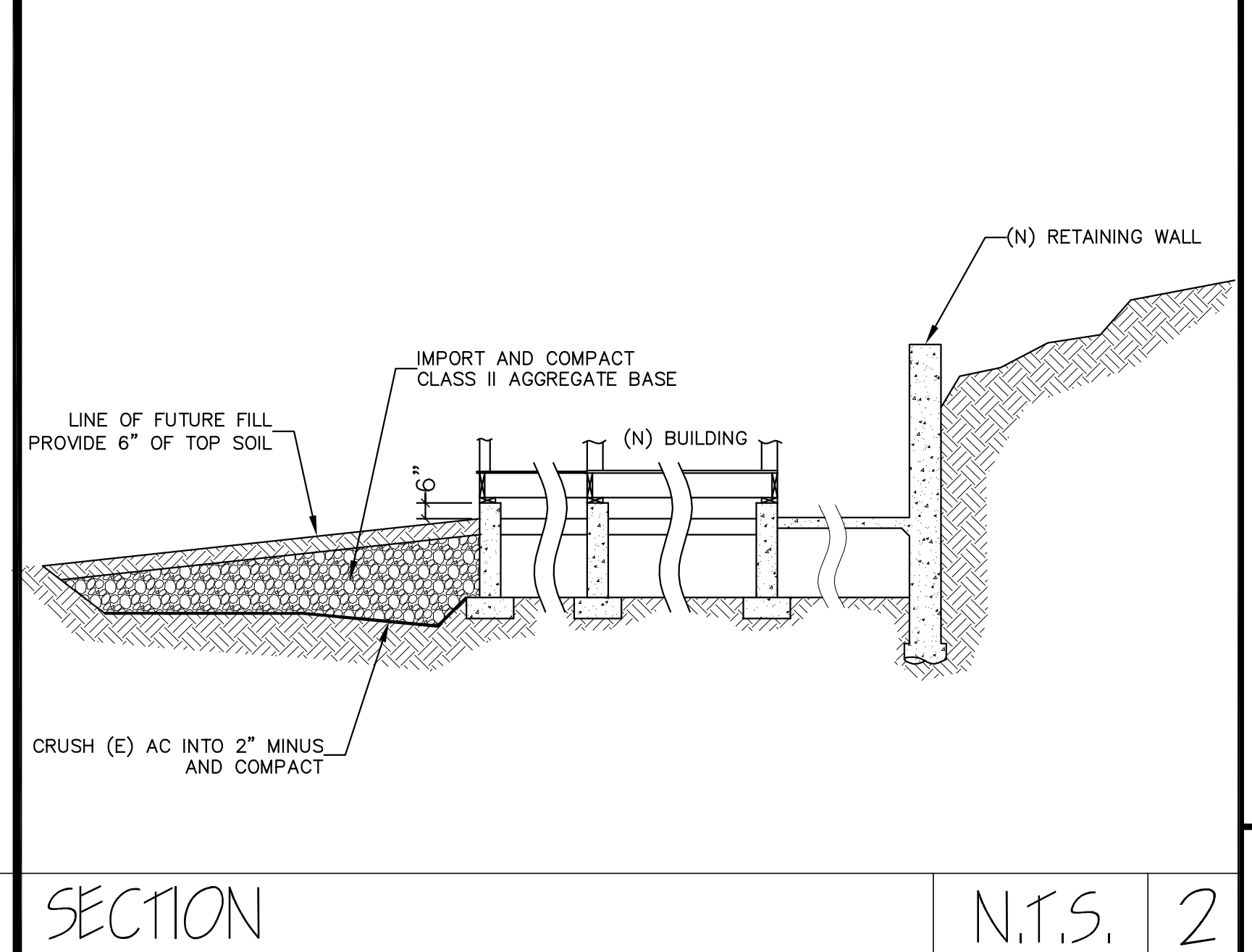
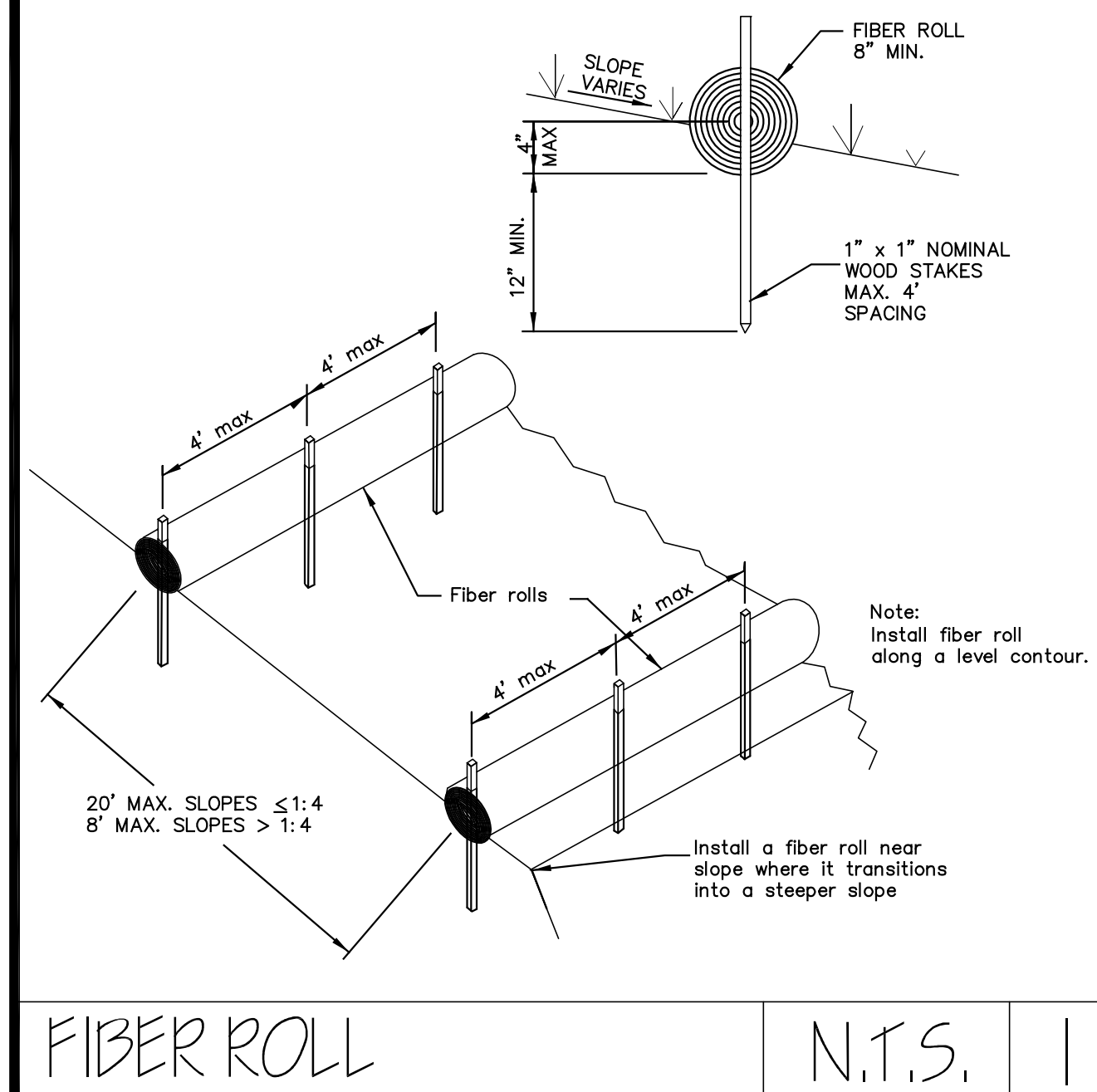

FIBER ROLL N.T.S. 1 SECTION N.T.S. 2

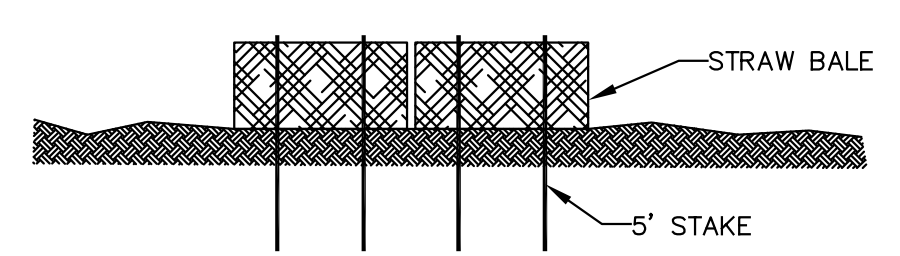
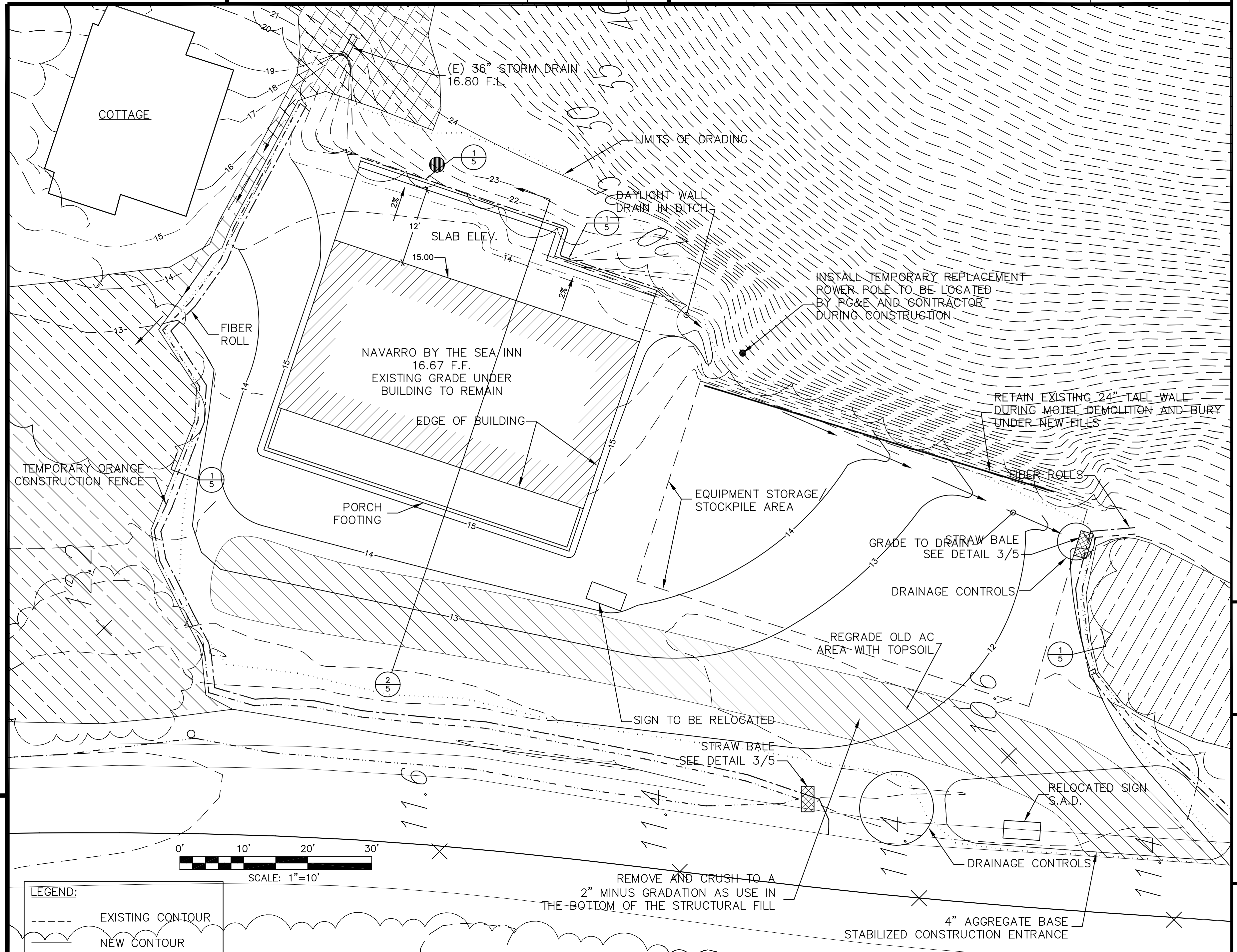

STRAW BALE PIN DETAIL N.T.S. 3 PLAN N.T.S. 4

I.L. WELTY & ASSOCIATES
703 A North Main Street
Fort Bragg, California 95437
Telephone (707) 964-8865

FINAL EROSION CONTROL PLAN
NAVARRO BY THE SEA
A PORTION OF NAVARRO RIVER REDWOODS STATE PARK
ALBION, CA

JOB #07007.00
DRAWN FF
DATE 2/2010
SCALE AS SHOWN
APPROVED
R.C.E. 19461

REGISTERED PROFESSIONAL ENGINEER
Ivan Lee Welty
No. 19461
EXP. 9/30/11
CIVIL
STATE OF CALIFORNIA

SHEET
5
OF 7 SHEETS